

MY MISSOURI ALLREDS

Karen Watts, Judy Scherer, Fred Gilbert, Viola Allred,
Richard, Thomas, William, Solomon, Theophilus, Solomon
born 1680 Lancashire, England

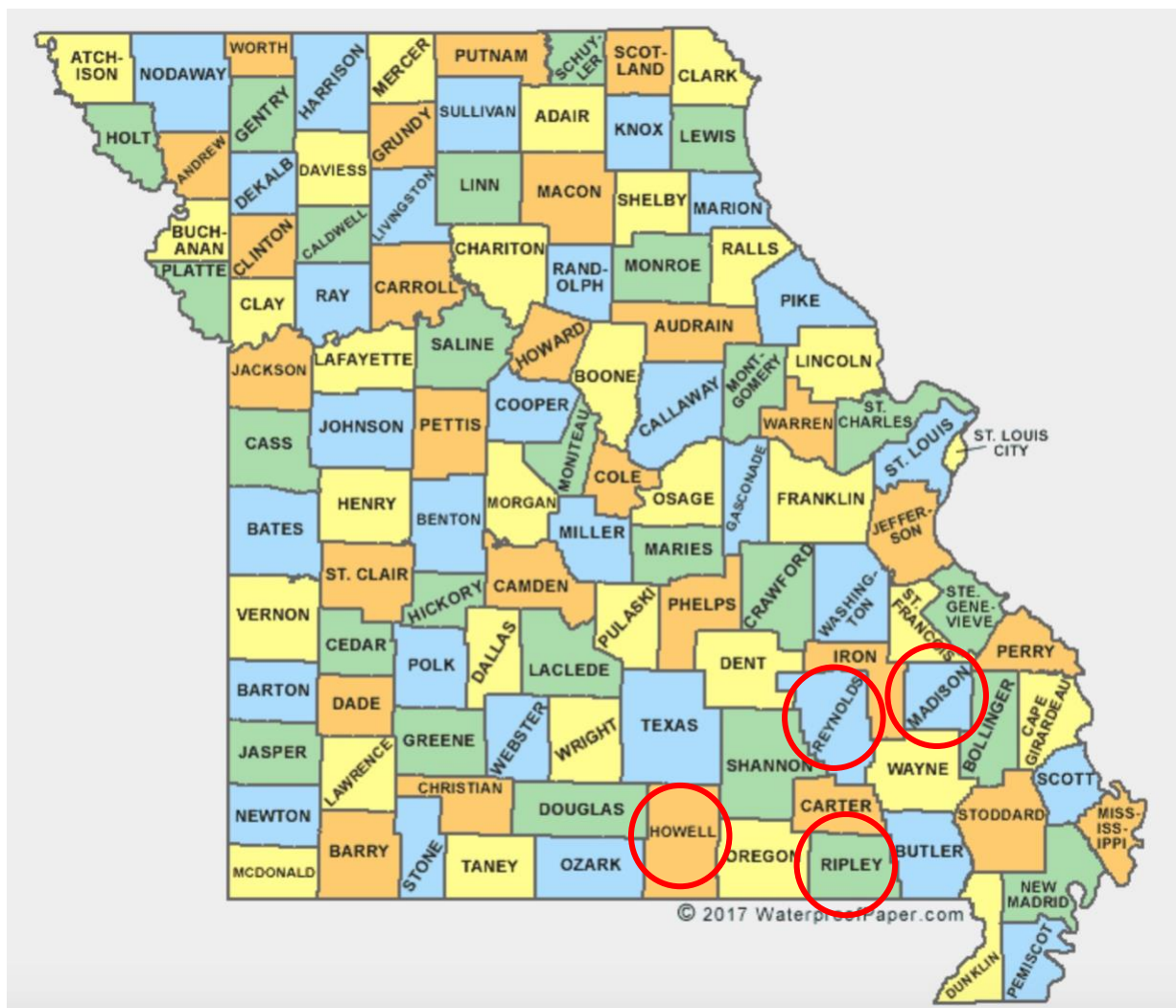

*Missouri Counties
Homes to 3 generations of Allreds*

My grandfather, **Fred C. Gilbert**, was the proud guardian of the Gilbert family bible, which documented his paternal line back to 1768. He told us that his mother was an **Allred** from Missouri and the family called his grandfather **Squire**. Imagine my delight when I found **Squire C. Allred** in the 1850 Census for Madison County Missouri! He was 11 years old, living with his parents **Thomas B.** and **Eliza Allred** and 5 siblings. He was born in Tennessee, as were his parents, 2 older siblings, and one younger sibling. The two youngest children were born in Missouri (*App 1*).

Thomas B. Allred is listed in the 1840 census records in Overton TN, District 9. He is between 20 and 30 years old, married, with 3 children under the age of 8 (2 boys and a girl) (*App 2*). This is consistent with the data in the 1850 census in Madison MO.

So...who were **Thomas B.'s** parents?

The 1830 census for Overton County TN shows that **William, Solomon Jr., John, and Solomon Allred Sr.** are neighbors (*App 3*). **Solomon Sr.** died in 1835 and his will names **Solomon Jr, William B., and John** as his sons (*App 5*). Land transaction records in Overton County TN in 1838 indicate that **John, William B., and Solomon Jr.** are brothers, all sons of **Solomon Sr.**(*App 4*). I have several DNA cousins that have been identified by Ancestry.com among the Tennessee/Missouri Allreds. Four are descendants of **William B.** and his wife **Mary Polly Brown**, and one is a descendent of **Solomon Jr.** There are no official documents that identify **Thomas B.'s** father, but there are several ways that **Thomas B.** is connected to **William B.** I believe that **William B.** is most likely **Thomas B.'s** father, for the following reasons:

- According to the 1830 census in Overton County, **William B.** is the only one of the 3 brothers with a son in the right age range to be **Thomas B.** (*App 3*).
- **Thomas B.** named his oldest son **William** (*App 1*).
- **Thomas B.'s** 1850 census records include a female pauper named **Brown**, 45 years old. If **Mary Polly Brown** was **Thomas's** mother, **Female Brown** may be a relative (*App 1*).
- By 1850 both **William B.** and **Thomas B.** are living in southeastern Missouri (*App 1, App 6*). **Solomon Jr.** was still in TN.

William B. was born in Randolph County NC in 1797. **Mary Polly Brown** was born in NC in 1796. They had 13 children between 1813 and 1837, all born in Tennessee (*Ancestry.com*). As previously noted, his father **Solomon** died in 1835. In 1837 his mother **Sarah** died (*Ancestry.com*) and he began to sell his land. Between 1838 and 1840 **William B.** sold at least 127 acres in Overton County TN (described as being adjacent to **Solomon Allred's** land) to **Thomas Brown** and **William Looper** (*App 7*). According to the 1840 Census, **Thomas Brown** was a neighbor, perhaps related to **Mary Polly** (*App. 3*).

Five of **William B.'s** daughters married into **Boswell, Newberry, Asberry** and **Deese** families. In 1840, according to the Census, **William B.** and all of these families lived in Overton County TN. In the 1850 and later census records, they are all in Missouri or Illinois (*App 8*). **William B.** settled in Reynolds County, in southern Missouri (*App 6*). His oldest

son **Thomas B.** settled in Madison County MO. Entire extended families and their neighbors typically migrated together, and it is likely that these people were all a part of the same wagon train. **Mary Polly** died in 1842 in Reynolds County MO (*Mary Brown Allred*).

Reynolds County was part of the South Courtois Hills, in the Ozark Highlands. The greatest number of settlers in the area came from Tennessee between 1820 and 1860. It would have been similar to Overton County and it is likely that **William B.** knew some of the Tennesseans already settled there. In fact, one of his neighbors in Overton County, **Gamblin Weeks**, was the sheriff of Reynolds County in 1850. The terrain was hilly, with stream valleys below and gentle inclines with tillable slopes and grazing land above. Slopes provided easy access to water but safety from flooding. Farmsteads were widely dispersed. The culture was based on economic self-sufficiency, as the nearest markets were 40 miles away. Settlers farmed (mostly corn), hunted, and had unrestricted use of unclaimed land to run their livestock (*Clendenen*).

The **1850 Census** (*App 6*) lists **William B.** with five of his youngest children in Reynolds County MO, District 76, as follows:

William B., age 62, farmer, born in NC, real estate \$400
Jonathan, age 27, born in TN
Daniel, age 21, born in TN
Amanda, age 17, born in TN
Nancy, age 13, born in TN
Martha J, age 11, born in TN

Four of my Ancestry.com DNA cousins are descendants of **William B.** and **Mary Polly Allred**. All are ranked as 4th-6th cousins (*Ancestry.com*). Only **Amanda Ann** was young enough to be listed with **William B.** in the 1850 Census.

- **Mary Ann**, b. 1815 in Overton TN, d. 1886 in Overton TN, married **Benjamin Norrod**.
- **Margaret**, b. 1817 in Overton TN, died 1887 Jefferson ILL, married **Joseph Newberry**.
- **Rebecca Ann**, b. 1824 in Overton TN, died 1863 in Johnson AR, married **Joseph Looper**.
- **Amanda Ann**, b. 1832 in Overton TN, married **Nathan Asberry**.

William B. died between 1850 and 1860 and is buried in the Ratliff Cemetery in Reynolds County MO (*Ancestry.com*).

Thomas B. and his family settled in Madison County MO, which is east of Reynolds County, almost to the Illinois border (see map). **Thomas B.'s** wife was **Eliza McClellan** (*Ancestry.com*). They were my 3X great grandparents. They lived in Fredericktown, formerly a French village named St. Michael's (*App 1*). Based on the places and dates of birth of their children we can assume they arrived in Missouri between 1841 and 1846 (see

below). Household members, as listed in the **1850 Census** (*App 1*) in Madison County MO, were:

Thomas B., age 37, born in TN, a farmer (side notation says "County Farm")
Eliza S., age 33, born in TN, a teacher
William M., age 14, born in TN in 1836
Sarah T., age 13, born in TN in 1837
Squire C. (Richard, my 2X great grandfather), age 11, born in TN in 1839 (died in Howell Co MO in 1917)
Eliza A., age 9, born in TN, in 1841 (died in St. Louis MO in 1919)
James M., age 4, born in MO, in 1846 (died in Jefferson Co MO in 1925)
Susan E., age 3/12, born in MO, in 1850
Reba McClellan, age 55, born in TN, a pauper (**Eliza's** mother?)
Female Brown, age 45, born in GA, a pauper (a relation of **Mary Polly, Thomas B.'s** mother?)
John Farrin, 37, born in MO, a pauper

The topography of Madison County was different from Reynolds County, all irregular gently rolling hills and valleys (all under 600 feet). The first white men arrived in 1721-23, surveying for minerals. They found lead, zinc, cobalt and nickel. Settlers didn't arrive right away because there was no silver. There were migratory miners in the area between 1725 and 1800. Farmers sold their goods in mining areas. There was also a lumber industry and cattle ranching (*Madison County*). Madison County is noted for mining of lead and quarrying of marble, sandstone, limestone, and granite. However, its principle resources are the agriculture and stock raising enterprises that grew up to support the mining community.

Thomas B. died in 1858 (*Ancestry.com*) and **Eliza** must have remarried right away. The **1860 Census** lists her as **Eliza Matlock**. The children listed with her match the younger ones listed with **Thomas B.** in 1850, plus 8 year old **Nancy Allred** and 3 year old **Catherine Matlock**. **Squire C.**, who would have been about 19 years old, was not a part of the household. There was no husband listed in 1860 and no check under the "Married in 1860" column (*App 9*). Presumably she was already widowed again or divorced. If **Catherine** is her child, **Thomas B.'s** death date is likely incorrect. The alternative is that **Catherine** was **Eliza's** 2nd husband's daughter prior to their marriage.

The **1860 Census** (*App 9*) in Madison Co MO lists the following family members:

Eliza Matlock, age 44, born in TN, farmer, personal estate \$200
Eliza A Allred, age 18, born in TN, domestic
James Allred, age 13, born in MO
Susan Allred, age 10, born in MO
Nancy Allred, age 8, born in MO
Catherine Matlock, age 3, born in MO

Eliza Allred Matlock died in 1862 (*Ancestry.com*).

Richard C. Allred (aka Squire C.) was my 2X great grandfather. He was born in Overton TN in 1839 and he died in Howell County MO in 1917. He was between 2 and 7 years old when his family made the journey from TN to MO (*App 1*).

Richard C. was about 19 years old when his father **Thomas B.** died in 1858 (*Ancestry.com*). The **1860 Census** shows that he was still living in Madison County MO, with the following family (*App 10*):

Michael McCarron, age 47, born Ireland, a blacksmith, \$1000 real estate, \$3000 personal estate

Parmella, age 37, a domestic

Margaret, age 10

Nancy, age 5

James, age 3

Michael, age ½

Richard Allred, age 20, born in MO, \$25 personal estate

His 4 younger siblings were still living with his mother, also in Madison Co MO (*App 9*). His older brother **William M.** and older sister **Sarah T.** were old enough to be on their own by then. I haven't been able to find out anything more about either of them.

Civil War in Missouri

Missouri entered the United States as a slave state under the Missouri Compromise of 1820, which declared that for every slave state to enter the Union a free state must be admitted. It was heavily settled by southerners. During the Civil War it was a border state on the edge of the frontier and a battleground for both sides. There were about 110,000 troops fighting for the Union and about 40,000 fighting for the Confederacy (although many joined Confederate units in other states). The state was part of the "Trans-Mississippi Theater". The Missouri River was strategic in the fight for control over the Mississippi River. To control a river, you have to own both sides of it and control its major tributaries. The Union Army controlled the east bank early in the war. The battle to control the west bank was the focus of the Trans-Mississippi Theater (*The Civil War in the Trans-Mississippi Theater*). Throughout the war, from 1861 to 1865, there were battles and skirmishes on Missouri soil. There were many non-military groups of bushwackers (Confederate sympathizers) and Jayhawkers (Union sympathizers) that harassed the civilian population through acts of guerilla warfare. Local communities were expected to raise forces to combat the vigilantes. The level of violence and brutality in Kansas, Missouri and Arkansas was unmatched anywhere else during the Civil War (*Missouri in the Civil War*).

The major conflict in Madison County was the Battle of Fredericktown (**Richard C.**'s hometown) on October 21, 1861. A Union victory consolidated control of southeastern Missouri. Union officers believed that the locals had supported the Confederacy, so homes

and buildings were burned in retaliation after the battle. (*Engagement at Fredericktown*). Later that year, Company E of the 2nd Missouri Cavalry (Confederate) was formed in Springfield, commanded by **William M. Couzens**. **Richard C.** enlisted as a private on Jan. 28, 1862 (*App 11*). He was 21 years old. In April of 1862 the 1st, 2nd, and 3rd Missouri Cavalry regiments were transferred to the east side of the Mississippi River. All were forced to dismount and learn to fight as infantry. The 2nd Missouri Cavalry was the only one remounted during the war. They fought in Mississippi, Tennessee and Alabama (*Short History of the 2nd Missouri Cavalry*).

Richard C.'s Marriage and Family

Richard C. survived the Civil War and married **Mary Caroline Wright** on November 9, 1865 (*App 12*). She was born in 1844 in Madison County MO. **Richard C's** uncle **Jonathan (William B.'s son, from Reynolds County)** also ended up in Madison County, where he married **W. M. Wright** (a relative of **Mary Caroline Wright?**) (*Ancestry.com*).

According to the 1870 Census **Richard C. ,Mary,** and their first child **Viola Virginia** (my great grandmother) were residents of Current River, Ripley County MO (*App 13*).

Richard Allred, age 31, born in TN, farmer, real estate \$300, personal estate \$150

Mary, age 26, born in MO

Viola, age 1, born in MO

Ripley County is southwest of Madison County in the Ozark foothills. It was rugged and sparsely populated. The court house in the county seat at Doniphan burned (along with most of the town) during the Civil War, in 1864. Many record books were removed prior to the burning and survive because they were hidden in a cave south of town for 2 years. During the War the county was strongly pro-Southern. Several skirmishes occurred there. Today it is a tourist area, part of the Mark Twain National Forest (*Ripley County Missouri*).

In 1875 **Richard C.** and his family moved to Howell County MO (*App 14*). The Census records of 1880, 1900 and 1910 all place them there. **Richard C.** engaged in a variety of occupations over the years—druggist in 1880, farmer in 1900, carpenter in 1910 (*App 15*). The census records indicate that they had a total of five children—

Viola, born 1868 in MO

William W., born 1872 in MO

John F., born 1874 in MO

Charley, born 1883 in MO

Annie, born 1887 in MO

On January 5, 1892, **Richard C.** claimed 160 acres in Siloam Springs, Howell County, as part of the Homestead Act of 1862 (*App 16*). The law was enacted to facilitate western settlement. It granted adult heads of families 160 acres of surveyed public land for a filing

fee, if they had been living on the land continuously for at least 5 years. He must have settled the land sometime before 1887. Modern plat maps of the area have the same designations as they did in 1892, and we can identify the land that he claimed based on the description on his land patent (*App 18*).

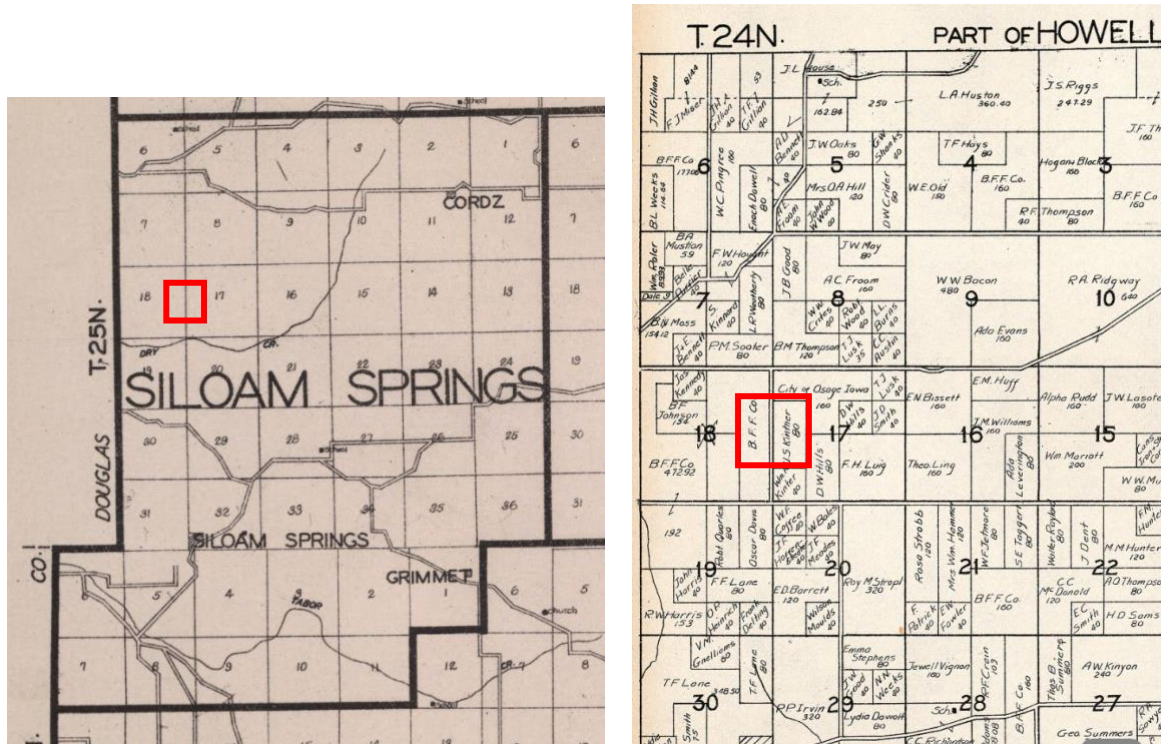

Richard C's land in Siloam Springs, 1892

Siloam Springs was a noted health resort in the late 1800s. A mineral water craze spread across the country and people came from miles around to visit. It was named by Dr. Jonathan Brown in 1878 after a healing pool in the Bible (*Howell County Place Names*). Dr. Brown put in a small bath house and showers, then sold the place to D.F. Martin in 1880.

Mr. Martin made considerable improvements and began advertising. His brochure stated that:

- the springs were making themselves a wonderful reputation for their varied healing virtues in chronic diseases of all forms
- thousands of people had visited the resort
- numerous cases could only be described as miraculous cures
- the town had 120 dwellings, several hotels or boarding houses, three general stores, two drug stores, and one livery stable
- homes suitable for small families were available to rent for two or three dollars a month

The town was renamed Martinsville, but Siloam Springs remained the name of the post office. Between 1880 and 1910, the years that **Richard C.** and his family lived there, the

resort prospered and reached a population of 600 residents. Under new ownership in the early 1900s, electric lights and a modern sewer system were installed; the springs were cleaned and walled; parks and playgrounds and a lake for swimming and boating were made; two hotels and cottages were erected. Such was the environment that my great grandmother, **Viola Allred**, grew up in. It declined over the years and the post office closed around 1969 (*Wood*).

On June 11, 1913, at the age of 74, **Richard C.** applied for a Civil War pension. His application stated that he was discharged due to chronic disease, that he was in no important battles, and that he had been recognized by the Daughters of the Confederacy. His pension was initially rejected on the grounds that he was a deserter, which he vehemently denied. He exchanged several letters with officials in the Adjutant General's offices in both Missouri and Washington D.C. He eventually established an accurate record of his service, which paralleled the history of the 2nd Missouri Cavalry (*Short History of the 2nd Missouri Cavalry*). He also had a friend write on his behalf.

At one point he writes:

"Must confess that I am out of patience with this matter. Of course I need the pension or I would not applied for same."

A friend wrote on his behalf:

"I am an old federal soldier, get a pension from the gov. but the war is over with now and I will do anything that is right for an old Confederate. This old man is needy, and worthy."

His pension was granted on August 20, 1913 (*App 17*). The time between his original application and the award date was just over 2 months. This is pretty impressive given that communications involved several people (some in government offices) and were all done by regular mail.

Richard C. died of "la grippe" (malaria or the flu) on Jan 28, 1917 (*App 18*), at the age of 77. Malaria may have been the "chronic disease" mentioned in his Civil War discharge papers that eventually led to his death, or he may have contracted the flu that would eventually be called H1N1 in 1918. The first documented case of H1N1 in the United States was in Haskell Co KS in January of 1918. However, a trend of increasing flu mortality in MO was noted as early as 1915. The 1918 flu pandemic was the deadliest in the 20th century (*Flu Pandemic of 1918*).

His obituary, published in the West Plains Quill on Feb 1, 1917, reads as follows:

PIONEER RESIDENT OF SILOAM SPRINGS DIES FEW DAYS AGO

***RICHARD C. ALLRED**, 71, a resident of Siloam Springs since 1875, coming from Tennessee was a Confederate soldier during the Civil War. Survived by widow and*

children, Mrs. Hal Gilbert, Mrs. Clint Wilson, Mrs. Robert House, Will & Charles & John Allred.

He is buried in the Siloam Springs cemetery (*Richard C. Allred*).



According to the 1920 census, his widow **Mary**, age 75, was living with her youngest daughter **Annie House**, 32 years old, and her 2 year old granddaughter Margie Anne, in Pawnee OK (*App 19*).

By the 1930 census **Mary**, age 86, was living with her youngest son **Charley Allred**, a widower and farmer, in Pawnee OK (*App 20*).

Mary died in 1935, age 90, in Pawnee OK, of asthma/pneumonia (*App 21*). She is buried in Woodland Cemetery in Cleveland, OK (*Mary Caroline Wright Allred*).



Richard C. and Mary's oldest daughter, **Viola Virginia**, my great grandmother, married **William Henry Gilbert** on August 9, 1891 in Siloam Springs (*App 22*). By 1900 they were living in Arkansas and had 5 children. They were to have 7 children in all, one born in a tent in Texas. Most census records found them in a different state, with **William Henry** listing a different profession. In 1900 he was a photographer in Arkansas, in 1910 he was a carpenter in Arizona, in 1920 he was a silver miner in Arizona, in 1930 he was a farmer in New Mexico (*App 23*). My grandfather, **Fred C. Gilbert**, always said that his father spent his life looking for greener pastures. **Fred** married in Texas, then found his way to

California, working as a salesman for a chemical company that served the oil fields. He settled down, founded his own company, and raised two daughters, all in the same town where I grew up. The company is still in business and has supported 4 generations of my family. He and my grandmother were the family's first genealogists, followed by my mother and myself.

BIBLIOGRAPHY

Ancestry.com. All Ancestry.com references are to other members' trees. They are mostly undocumented.

Clendenen, Harbert Leslie. *1973 Settlement Morphology of the Southern Courtois Hills, Missouri, 1820-1860*. Dissertation, Louisiana State University and Agricultural and Mechanical College. Digital commons.lsu.edu/gradschool_disstheses/2384.

Engagement at Fredericktown. Wikipedia. Accessed March, 2020.

Flu Pandemic of 1918. ncbi.nlm.nih.gov. Accessed April, 2020.

Howell County Place Names, 1928-1945, Siloam Springs. Shsmo.org. Accessed March, 2020.

Madison County, genealogytrails.com. Accessed March, 2020.

Mary Brown Allred. Find A Grave Memorial 118228654. Maintained by Betty Radford. Findagrave.com. Accessed March, 2020.

Mary Caroline Wright Allred. FindAGrave Memorial 19235374. Maintained by PAllred. Findagrave.com. Accessed February, 2022.

Missouri in the Civil War. Wikipedia. Accessed March, 2020.

Richard C. Allred. Find A Grave Memorial 135298618. Maintained by Linda S. Caldwell. Findagrave.com. Accessed February, 2022.

Ripley County Missouri. Wikipedia. Accessed March, 2020.

Short History of the 2nd Missouri Cavalry. 2ndmocavcsa.tripod.com. Accessed April, 2020.

The Civil War in the Trans-Mississippi Theater. Exploringoffthebeatenpath.com. Accessed April, 2020.

Wood, Larry. *Missouri and Ozarks History: Siloam Springs*. Ozarks-history.blogspot.com/Dec. 18, 2016. Accessed March, 2020.

APPENDICES

APPENDIX 4. John Allred land sales to Magnus Looper, referencing Allred siblings

In presence of
 Chosen from John Allred to Magnus Looper
 Fred on the third day of ^{more} February one thousand eight hundred & forty one
 John Kennedy Registrar

John Allred
 Deed 40 acres
 held by Grant
 lying on the
 Waters of the West Fork
 Magnuss Looper

This indenture made this twenty fifth day of
 July in the year of our Lord one thousand eight
 hundred and forty one, by and between John
 Allred of the State of Tennessee, and County
 of Warren of the one part: and Magnus Looper
 of the Same State and County of the other part
 witnesses that the said John Allred for and in con-
 sideration of the sum of four hundred and seventy five dollars to him in hand paid by the
 said Looper the receipt of which is hereby acknowledged hath this day bargained sold aliened
 in perfect conveyance and confirmed unto by these presents doth bargain sell alien assign
 convey and confirm unto the said Magnus Looper his heirs and assigns forever a certain tract
 or parcel of land containing forty acres more or less held by said Allred Beginning at the
 Beginning corner of a hundred and seven acres at a dogwood and horn beam: North fifty two
 degrees West with a conditional line between him & Solomon Allred the South corner of his
 section: thence with the fence with fifty five degrees West in all 75 poles with said fence
 to a certain stump: thence to some stumps in a fence row at the corner of a small lot: thence
 north 44° East with the said fence the Conditional line between John Allred and Solomon Allred
 increased: thence a straight line with said fence to the line: thence with said line Eastwardly with
 said line to the said Solomon Allred's corner: thence Southwardly with said line across the
 section to the corner of said line: thence South Westwardly to the Beginning to include the lands
 the said John Allred holds in the same tract by Solomon Allred's claim do here and to hold to

to him the said Magnus Looper his heirs and assigns forever the aforesaid described land 40
 of land and bargain premises together with all and singular the hereditaments and
 appurtenances thereto belonging or in any wise appurtenances and every part and parcel thereof
 and the said John Allred for his part and himself his heirs executors and administrators and assigns
 unto the aforesaid tract of land or parcel and bargain premises with all and singular the heredita-
 ments and appurtenances thereto belonging unto him the said Magnus Looper his heirs and assigns
 forever with warrant and forever defend for himself his heirs and assigns executors and adminis-
 trators in Testimony whereof the said John Allred hath hereunto set his hand and affixed his seal
 the day and date above written. Signed sealed and delivered in the presence of us
 Allst Thomas Deaman
 William Beswell
 John Allred Seal

I Solomon Allred and William Allred heirs of the said Solomon Allred deceased believe that
 John Allred is entitled to be entitled to the within described land and in violation to assign these
 and all these claims to the same land
 William Allred
 Solomon Allred

State of Tennessee
 Warren County I personally appeared before me John S Dougherty Clerk of the County
 Court for said County William Beswell and Thomas Deaman the subscribing witnesses to the
 foregoing and who upon their oath did say that they were acquainted with John Allred Wil-
 liam Allred and Solomon Allred the foregoing conveyors that they saw them execute the within
 deed to Magnus Looper for 40 acres of land on the day it bears date for the purposes therein
 contained Given under my hand at office the 25th day of February 1841
 John S Dougherty Clerk

The foregoing is a correct register of a deed from John Allred to Magnus Looper of the
 said State of Tennessee who of the relinquishment of William & Solomon Allred thereto Subjunct
 and was registered & certified on the third day of March one thousand eight hundred and
 forty one
 John Kennedy Registrar

Franklin Adams
 Deed 40 acres held by

This indenture made and entered into this the twenty second
 day of January one thousand eight hundred and forty one

APPENDIX 5. Family History, Cowboy2000 (Ancestry.com), Personal Correspondence

Karen,

My Solomon's land was transferred in his will. He said, John, Solomon Jr, and William B "were his sons." John got the property where house and graves were. Also, he mentioned Rebecca Allred (his daughter and John's sister...Solomon Jr and William B's half sister) She was widow to William Stringfellow who died in Barnwell County, S.C. about 1814 before. Once her brother followed his children to Georgia from Barnwell County after 1820, she moved to Overton County, TN where her father, brother, John, and half brothers live. Solomon listed her as Rebecca "Allred" in will and land transfer.

John had moved to Conway, Arkansas (in 1840 census). William B moved about 1841 and in 1850 Reynolds County, Missouri.

Jim Allred

Karen,

When I was in Livingston, there was an older couple who managed the older land records (not at court house or library)and helped me find the land transferred by will of Solomon Sr. I have a copy of it here somewhere. Unfortunately I invited my older brother, from Austin, Texas along on that trip, thinking it could be a bonding experience. He could care less about genealogy and who his ancestors were. He just wanted to go to Nashville. He reminded me of a young 7 year old, expecting me to find entertainment for him while I did my research. He could not understand why I spent so much time on dead people. I told him that those "dead people sacrificed through a lot of hardship so that one day, you could live and that their blood was coursing through your veins." He looked like I had smacked him across his face. However, that lasted for about 30 minutes. :0)

Still going through physical therapy for my shoulder. Life is a B**** when you get older. The younger ones bounce back like nobody's business, me, no so much. The move went pretty smooth. I paid for a packer and movers and friends helped me tremendously. I just looked at labels on boxes and directed the movers where to drop the boxes. I still have boxes everywhere but slowing making progress.

Oh yes, William B and Solomon Jr received a land grant for military service in 1814. I think that info is on my tree. In fact, the land will transaction might be too. "Sales from William B to Thomas Brown and William Looper," I believe both were brothers-in-laws (look at my tree). I know that William B and Weeks and Brown relatives also moved to Reynolds. My great great grandfather, Gamblin Weeks was sheriff of Reynolds County in 1850 census. Gamblin had also married a Brown, who died, and he had married a widow who had grown children and were the bullies and county helliuns. Gamblin packed up in 1851-2 (without

his second wife) and moved to Pope County, Arkansas along with his daughter, Sarah Jane (Weeks) Allred and my 3rd great grandfather, Solomon Allred, son of the Solomon Allred Jr. They had moved to Reynolds sometime after the 1850 census of Overton County, Tennessee. You will find both Solomons that I mentioned in the last sentence still in the 1850 census of Overton County, 9th District. [Yes, there was another Solomon Allred in 10th District, Overton County, TN in 1850 sentence. Ignore him.

Jim

Research by Jim Allred, from land records in Livingston, Overton TN

Most have accepted the research that Rulon Clark Allred and his many wives and children had guessed and they did a pretty darn good job overall in their book, "The Allred Family in America - Volume I". However, my 4th Great Grandfather, Solomon Sr, being 80-89 years old in 1830 Overton County, Tennessee, who was born between 1741 and 1750 and died there about 1835 was not in their research. My 3rd Great Grandfather, Solomon b 1784 was mentioned but they had him the son of Phineas.

The Solomon that has the most research and has been listed as being born abt 1732-4 (that date was arbitrarily chosen since he owned land in 1852 in Randolph County..20 years old?..but could have been much older), died about 1782 and his estate was inventoried on 26 December 1782. My belief is that Solomon Sr [my 4th Great Grandfather] b. about 1741 and living in Richmond County, NC was the Solomon who benefited from this Richmond County estate settlement rather than the Solomon born about 1770 in Randolph County, NC, who Rulon listed.

I also believe my 4th Great Grandfather, Solomon, to be the father of Phineas & Jonathan (or at least their older brother)

and is living next door or near in 1786 and 1790 census of Richmond County. I now know for sure that he is the father of John (b 1772) (probably by a first wife) AND that he is also the father of Solomon Jr [my 3rd Great Grandfather](b. 1784 my line) and Wm B (b 1787) all born in Richmond Co, NC.

The older children, Phineas & Jonathan (but not John) moved to Barnwell County, SC about 1800, along with their sister, Rebecca, who was second wife to Wm Stringfellow Sr. Wm Stringfellow Sr died there abt 1814 (Jonathan was a will co-executor with Rebecca). Phineas also died there between 1810-1820, leaving his wife, Bathsheba/Basheba. Jonathan's family have documented that after the 1820 census, Jonathan moved to Georgia where some of his children had moved. He died in Athens, Georgia in April 1822.

There are a lot of Solomons in the 1830 census of TN. The ones in my direct line lived clustered in what was later called the 9th District of Overton. In 1830, Solomon Sr [my 4th Great Grandfather] (b abt 1741), Solomon Jr [my 3rd Great Grandfather] (b abt 1784), William B (b abt 1787), John (b abt 1772), and Rebecca (Allred-b aft 1760) Stringfellow all lived next to each other there in that census.

Also, the other Solomon living in Overton County, Tennessee, but the 10th District, is the Solomon who was born abt 1770 in Randolph Co, NC and the one many researchers have attributed as the Solomon Jr who received a settlement of the Richmond County, Solomon Allred Sr estate inventoried in 1782. If this were the case, he would have only been 12 years old and any estate settlement would have mentioned him as a minor and who was to take care of his share until he reached age 20. I do not recall any one mentioning that. This Solomon (b. abt 1770) was living in his own grouping of children in the

10th District of Overton County, TN in 1830. This Solomon remained in Overton County, TN until his death, leaving his second (or third) wife, Sarah (Swallows) Allred listed with him in the 1850 census. If you look closely at that 1830 census, you will find the two separate groupings of my line and his.

I also now have documented proof via land record transactions that I copied while researching in Livingston, Overton, Tennessee, that specifically names John b 1772, my Solomon Jr [my 3rd Great Grandfather] b 1784, and William B Allred as "sons" of the Solomon [my 4th Great Grandfather] who died there abt 1835.

Another researcher has indicated that he believes that Solomon Sr [my 4th Great Grandfather-b abt 1741] may have been descended directly from the Solomon Alred who appears on the 1724 and 1730 Tax Lists for Chester County, Pennsylvania. I would like to agree with him and say that this Pennsylvania Solomon is probably the one that owned land in 1752 in Randolph County and who died in Richmond County in 1782.

Jim Allred

APPENDIX 6. William B. Allred, 1850 Census, Reynolds County MO

1850 United States Federal Census for William B Allred												
Missouri > Reynolds > District 76												
Dwelling No.	Family No.	Name	Age	Sex	Race	Occupation	Real Estate	Birthplace	Married	Attended	Cannot R	Condition
		Hannah So	12	F				So	✓			
10	10	William B Allred	62	M		Farmer	700	S. Carolina	✓			
		Jonathan So	27	M		Farmer		Tennessee	✓		1	
		Rejil So	21	M		Farmer		So	✓		1	
		Amianda So	17	F				So	✓			
		Nancy So	13	F				So	✓			
		Martha S. So	11	F				So	✓			
11	11	Gideon Weeks	52	M		Farmer		S. Carolina	✓		1	
		Ellen So	50	F				So	✓		1	
		Cassia So	21	F				So	✓		1	
		Martha So	16	F				Tennessee	✓			
		Jamiat So	13	M				Missouri	✓			
		Polly So	10	F				So	✓			
		Brooks Russell	30	M				Tennessee	✓		1	
		Sarah So	26	F				So	✓		1	

APPENDIX 7. William Allred's land sales to Thomas Brown and William Looper, 1838-1840, Overton County Register of Deeds Office, October, 2019, Karen and Dick Watts

FROM	TO	ACRES	COST	DATE	REG/CERT	OTHER
William Allred	Thomas Brown	50	200	1/1/1838	3/2/1839	Puncheon camp creek, including improvements where Thomas Brown now lives 3 rd district
William Allred	Thomas Brown	27	150	1/1/1838		12/12/1817, original survey w. fork Obed's River base of mountain, along a creek, including place where William Brown (?) lived 3 rd district, puncheon camp creek
William Allred	William Looper	50 (2 parcels)	100	9/7/1840	3/8/1841	2 parcels, west fork Obed's River, Sunk Cane 30 acres adjoining Solomon Allred Sr, granted to Wm. Allred #2558 6/12/1832 Including where Allred now lives Parcel 2, same as granted #3218 5/24/1837, including where Catherine Weeks now lives Witnesses Charles M. Allred and John York

**APPENDIX 8. Immigration of William B.'s family to Missouri and Illinois
(Ancestry.com)**

William B. Allred and Mary Polly Brown's family migrations

Name	Birth	1840C	1850C	1860C	1870C	1880C	Death
William B.	1787	Overton TN	Reynolds MO				Before 1860
Thomas B. m. Eliza McClellan	1813 Overton TN	Overton TN	Madison MO				1858
Sarah m. Brooks Boswell	1815 Overton TN	Overton TN	Reynolds MO	Jefferson IL	Jefferson IL		1910 Jeff IL
Mary Ann m. Benjamin Norrod	1815 Overton TN	Overton TN	Overton TN	Overton TN	Overton TN	Overton TN	1886 Overton TN
Margaret m. Joseph Newberry	1817 Overton TN	Overton TN	Franklin IL	Jefferson IL	Jefferson IL		1877 Jefferson IL
Rebecca Ann m. Joseph Looper	1824 Overton TN	Overton TN	Johnson AR	Johnson AR			1863 Johnson AR
Jonathan m. W.M. Wright	1826 Overton TN	Overton TN	Reynolds MO	Madison MO	Madison MO		
Daniel	1829 Overton TN	Overton TN	Reynolds MO				
Amanda Ann m. Nathan Asberry	1832 Overton TN	Overton TN	Reynolds MO	Reynolds MO			Before 1840
Martha Jane m. Alfred Deese, 1855	1837 Overton TN	Overton TN	Reynolds MO	Jefferson IL	Jefferson ILL		1874 Jefferson IL
Nancy M m. Nathan Asberry	1837 Overton TN	Overton TN	Reynolds MO		Reynolds MO	Reynolds MO	1934 Overton TN

APPENDIX 9. Eliza Allred 1860 Census, Madison County MO

1860 United States Federal Census for Eliza Matlock													
Missouri > Madison > St Francois													
Dwelling No.	Family No.	Name	Age	Sex	Color	Occupation	Real Estate	Personal Estate	Birthplace	Marri	Atten	Cann	Condition
										1860	Scho	Read	
		Lincy M. Langley	7	F					11				
		George M. Langley	3	M					11				
729	729	Eliza Matlock	44	F		Farmer	✓	200	Tennessee				
		Eliza M. Allred	18	F		Domestic	✓		11				
		James Allred	12	M					Missouri				
		Susan Allred	10	F					11				
		Stacey Allred	8	F					11				
		Katherine Matlock	3	F					11				

APPENDIX 10. Richard C. Allred 1860 Census, Madison County MO

1860 United States Federal Census for Richard Allred													
Missouri > Madison > St Francois													
Dwelling No.	Family No.	Name	Age	Sex	Color	Occupation	Real Estate	Personal Estate	Birthplace	Marri	Atten	Cann	Condition
										1860	Scho	Read	
		Uena Tolson	12	F					Missouri				
		William Tolson	15	M					Tennessee				
		John Tolson	3	M					Illinois				
775	775	Michael Mc Barron	47	M		Blacksmith	1000	3000	Ireland				
		Parmelia Mc Barron	32	F		Domestic	✓		Georgia				
		Margaret Mc Barron	10	F					"				
		Maray Mc Barron	5	F					"				
		James Mc Barron	3	M					Missouri				
		Michael Mc Barron	1/2	M					"				
		Richard Allred	20	M				20	"				
776	776	John D. Powell	34	M		Farmer	5000	2000	Ohio				
		Eura Powell	25	F		Domestic	✓		Ohio				

APPENDIX 11. Richard C. Allred Civil War Enlistment

MISSOURI SOLDIERS (1861-1865) WAR BETWEEN THE STATES

ALLRED R. C. (Siloam Springs) Pvt.
SURNAME GIVEN NAME RANK

Co. "E" 2nd Mo. Cav.
SERVICE

DATE ENLISTED PLACE OF ENLISTMENT

DATE PLACE KILLED PAROLED DISCHARGED

CONFIRMATION OF RECORD:

"Registered Record Ex-Confederate 1913" on file
Adj. Gen. Office--Jefferson City, Mo.

9

Roster of Company E, 2nd Missouri Cavalry, CSA

These names have been taken from the book, *Boys of the Best Families in the State—Company E 2nd Missouri Cavalry*, published in 2003. Company E filled its ranks with soldiers from the Missouri State Guard and attracted men from St. Francois, Ste. Genevieve, Madison, Washington, Iron, and Jefferson counties.

Bob Schmidt submitted this list that originally appeared in the Winter 2004 *St. Louis Genealogical Society Quarterly*, Vol. 37, No. 4, p. 140-141.

Roster of Company E, 2nd Missouri Cavalry, CSA

- View All In Document
- Refine Search

Roster of Company E, 2nd Missouri Cavalry, CSA	
Name	Ra
Allen, Jasper Newton	Pv
Alred, Richard	Pv
Andrews, Henry C.	Pv
Baker, William R.	Pv
Baker, William Wauber	Pv
Barnes, John	Pv
Beard, James	Pv
Beave, Henry	Pv
Blanks, Willis Perrin	Pv

APPENDIX 14. Richard C. Allred's Obituary

West Plains Quill on Feb 1, 1917:

PIONEER RESIDENT OF SILOAM SPRINGS DIES FEW DAYS AGO
RICHARD C. ALLRED, 71, a resident of Siloam Springs since 1875, coming from Tennessee was a Confederate soldier during the Civil War. Survived by widow and children, Mrs. Hal Gilbert, Mrs. Clint Wilson, Mrs. Robert House, Will & Charles & John Allred.

APPENDIX 15. Richard C. Allred Census Records, 1880, 1900, 1910

1880 United States Federal Census for R. Allred
 Missouri > Howell > Martinsville > 049

Street	House No	Dwelling	Family No	Name	Race	Sex	Age	Birth Mont	Relationship	Single	Married	Widow/D	Married C	Occupat	Mont	Sick	Blind	Deaf and	Idiotic	Insane	Disabled	Attended	Cannot r	Cannot w	Birthplace	Birthplace of	Birthplace of	
				Louisa	W	F	6		son																Missouri	Mo	Mo	
	1711			Richard C.	W	M	71							Bruggist											Tennessee	Tenn	Tenn	
				Mary	W	F	36		wife					at home											Missouri	Mo	Mo	
				Willa	W	F	11		daughter																Missouri	Tenn	Mo	
				William	W	M	5		son																Missouri	Tenn	Mo	
				Mary	W	F	6		son																Missouri	Tenn	Mo	

1900 United States Federal Census for Richard C Allred
 Missouri > Howell > Spring Creek > District 0060

Line Num	Street	House Num	House Num	Family No	Name	Relation to Head	Race	Sex	Age	Birth Month	Birth Year	Marital St	Years Mar	Children	Children	Birthplace	Father's Birthplace	Mother's Birthplace	Immigr	Natu	Years in U	Occupation	Months Attended	Can Read	Can Write	Can Speak	Own or R	Mortgage	Farm or	Sch	Veteran	Blind	Deaf
42					Mary M.	wife	W	F	42	Apr	1858	M	32			Mo	Mo	Mo				farmer	6	1	1	1							
43					Ernestine	daughter	W	F	12	Dec	1887	S				Mo	Mo	Mo					6	1	1	1							
44					Ernest L.	son	W	M	10	Aug	1889	S				Mo	Mo	Mo					6	1	1	1							
45					Carle E.	son	W	M	7	July	1892	S				Mo	Mo	Mo					6	1	1	1							
46		215	215		Richard C.	head	W	M	32	July	1860	M	32	2	2	Mo	Mo	Mo					6	1	1	1	1	1	1	1	1	1	1
47					Mary C.	wife	W	F	33	Mar	1867	M	33	8	8	Mo	Mo	Mo					6	1	1	1							
48					Charley L.D.	son	W	M	12	Feb	1888	S				Mo	Mo	Mo					6	1	1	1							
49					Assie L.	daughter	W	F	10	Jan	1890	S				Mo	Mo	Mo					6	1	1	1							
50		216	216		Richard C.	head	W	M	39	Dec	1860	M	39	6	6	Mo	England	England					6	1	1	1	1	1	1	1	1	1	1

1910 United States Federal Census for Richard C Allred
 Missouri > Howell > Siloam Springs > District 0086

Street	House No	Visited No	Family No	Name	Relation	Race	Sex	Age	Marital S	Years Mar	Children	Children	Birthplace	Father's Birthplace	Mother's Birthplace	Immigr	Naturaliz	Speaks English	Occupation	Industry	Emp Type	Out of Wk	Weeks w	Can Read	Can Write	Attended	Own or R	Mortgage	Farm or	Sch	Veteran	Blind	Deaf	
	11	11		Richard C.	head	W	M	49	M	35	3	3	Missouri	Missouri	Missouri			English	none	House	W	As 0	yes	yes	0	8	4	1	1	1	1	1	1	
				Mary C.	wife	W	F	35	M	35	4	4	Missouri	Missouri	Missouri			English	none	House	W	As 0	yes	yes	0	8	4	1	1	1	1	1	1	
	12	12		Ernest L.	son	W	M	18	S				Missouri	Missouri	Missouri			English	Merchant	dry goods	W	As 0	yes	yes	0	8	4	1	1	1	1	1	1	
				Ernest	son	W	M	5	S				Missouri	Missouri	Missouri			English	farmer	farmer	W	As 0	yes	yes	0	8	4	1	1	1	1	1	1	1

APPENDIX 16. Richard C. Allred Land Patent 1892

422



The United States of America,

TO ALL TO WHOM THESE PRESENTS SHALL COME, GREETING:

Homestead Certificate No. 701
 Application 7323
 United States a CERTIFICATE

Whereas there has been deposited in the GENERAL LAND OFFICE of the Register of the Land Office at Fronton Missouri, whereby it appears that, pursuant to the Act of Congress approved 20th May, 1862, "To secure Homesteads to actual settlers on the public domain," and the acts supplemental thereto, the claim of Richard Allred has been established and duly consummated in conformity to law for the North East quarter of the South East quarter, and the South East quarter of the North East quarter of section eighteen, and the North West quarter of the South West quarter, and the South West quarter of the North West quarter of Range Seventeen in Township twenty four North of Range ten West of the Fifth Principal Meridian in Missouri containing one hundred and sixty acres

according to the Official Plat of the Survey of the said Land returned to the GENERAL LAND OFFICE by the SURVEYOR GENERAL.

Now know ye, That there is therefore granted by the UNITED STATES unto the said Richard Allred the tract of Land above described: TO HAVE AND TO HOLD the said tract of Land, with the appurtenances thereof, unto the said Richard Allred and to his heirs and assigns forever.

In testimony whereof I, Benjamin Harrison President of the United States of America, have caused these letters to be made Patent, and the Seal of the General Land Office to be hereunto affixed.

Given under my hand, at the City of Washington, the fifth day of January, in the year of Our Lord one thousand eight hundred and Ninety two, and of the Independence of the United States the one hundred and sixty sixth

L. S.

By the President: Benjamin Harrison

By M. McKeon Sec'y.

D. P. Roberts, Recorder of the General Land Office.

APPENDIX 17. Richard C. Allred Application for Civil War Pension, Correspondence with Attorney Generals

MEMORANDUM OF SERVICE.

Entered service at city of Bloomfield, State of Ind
June 1861

Name of Colonel Commanding Regiment White
Full names of Captain and Lieutenants of Company Wm. A. in
Charly, Volby, Jasper Beck, & Peter Oshew
Letter or name of Company C.

Number or name of Regiment Seventh Wisconsin

Class of service, i. e., Infantry, Cavalry or Artillery Cavalry

Are you a member of any Confederate society? Daughter of
Confederacy

In what battles did you take part? No important battles

Note.—No attorney fees to be charged. Applicant to pay only necessary notary fees.

May 28, 1913—231.

Aug 20, 1913

Approved: Aug 20 1913

Pension for Ex-Confederate Soldiers

Application for the purpose of certifying those entitled to obtain pension under the terms of C. S. H. B. 465, 47th General Assembly, State of Missouri.

I DO SOLEMNLY SWEAR TO THE FOLLOWING FACTS:

- 1. That I am a bona fide resident of Missouri, and have been for two years preceding April 23, 1913, and am at present residing at Silvan Springs Missouri;
- 2. That I am an Ex-Confederate soldier and served for not less than six months in the army of the Confederate States of America in the late Civil War as per my record given below;
- 3. That I was honorably discharged therefrom and, as evidence, will submit my discharge papers to the Adjutant General of Missouri;
- 4. That I am not an inmate of the Confederate Home at Higginville, or any other similar institution, but that

(a) on account of wounds received (state nature of wounds) _____

(b) or on account of disease contracted (state nature of disease) chronic disease

(c) and on account of old age (state age) 74 years

I am incapacitated to labor, and have no business or profession or property from which I may derive an income, and no means sufficient for my support. (State if applicant has any property in wife's name, or if he has children or any other relations who should support him)

R. L. Allred
(Signature of applicant.)

Subscribed and sworn to before me this 11th day of June 1913.

John B. Hallingshad
Notary Public.

My commission expires April 7th 1915.

We, citizens of Silvan Springs Two, certify that we know the above R. L. Allred to be a man of reliability, and that the declaration above as made by him is correctly and truthfully stated.

R. L. Hallingshad
(To be signed by two citizens of city or county where applicant resides.)

AUG - 1
ADJUTANT GENERAL'S OFFICE
2063565 1913
WAR DEPARTMENT.

ADJUTANT GENERAL'S OFFICE
AUG 6
JEFFERSON CITY, MO.
1913

2063565 WAR DEPARTMENT, 124
THE ADJUTANT GENERAL'S OFFICE,
WASHINGTON, August 2, 1913.

Respectfully returned to the
Adjutant General,
State of Missouri,
Jefferson City.

The Confederate records show that
Richard Alred (name not found as R.C.
Allred), aged 21 years, private,
Company E (Captain William Couzen's
Company), 2d Missouri Cavalry, Con-
federate States Army, enlisted January
28, 1862, at Clarkston, Missouri, and
that he deserted July 16, 1862. No
later record of him has been found.
No record has been found of any
physical disability in the case of
this soldier.

Aug 2, 1913

H O S Heistand
Adjutant General.
7

June 10

Silvian Springs Mo
June 10 13

Hdq. General

Dear Sir

Jefferson City Mo
The Officers mentioned
in enclosed Blank that I
served under in state service
under Gov. Jackson's call,
we were only disbanded not
discharged but I reinlisted in
the regular service and we
were ordered East of the river
and I served until 1863
under the same Captain
and under Col. Bob McCollough
and contracted the disease

mentioned in Blank, and
was discharged on account
of it, but my discharge got
misplaced but if anything
more is required let me
know and I will answer you
immediately.

Very Respt Yours

R. C. Allred

Silvian Springs Mo

I hold a Cross of Honor in
the United Daughters of the
Confederacy conferred on me
in 1911.

Jefferson City MO

Dear Sir,

The officers mentioned in enclosed blank that I served under in state service under Gov. Jackson's call, we were only disbanded not discharged but I reinlisted in the regular service and we were ordered east of the river and I served until 1863 under the same Captain and Col Bob McCollough and contracted the disease mentioned in blank and was discharged on account of it, but my discharge got misplaced but if anything more is required let me know and I will answer you immediately.

Very Respt Yours,

R.C. Allred

Silvian Springs MO

I hold a Cross of Honor in the United Daughters of the Confederacy conferred on me in 1911.

Submitted June 11, 1913 and approved Aug 20, 1913

July 1, 1913

Siloam Springs Mo July 1st 13
Adj. General, U.S. A.
Washington D.C.

My Dear Sir:

Is there on file in your office a record of the Confederate armies? If so, please inform me how to proceed to get the record of service of one of them.

An old Confederate soldier has applied for a pension under the law passed by the Legislature of Missouri and he has no discharge. The Adj. General informs him he must get a record of his service from the records of the Confederate Army now on file in your office.

I am an old Federal soldier, get a pension from the Gov. but the war is over with now and I will do anything that is right for an old Confederate. This old man is needy, and worthy. Please let me hear from you.

Very Respectful

John W. Wilkerson
Siloam Springs, Mo

Siloam Springs MO July 1st 13

Adj. General U.S.A.

Washington DC

My Dear Sir:

Is there on file in your office a record of the Confederate armies. If so, please inform me how to proceed to get the record of service of one of them.

An old Confederate soldier has applied for a pension under the law passed by the legislature of Missouri and he has no discharge. The Adj. General informs him he must get a record of his service from the records of the Confederate Army now on file in your office. I am an old federal soldier, get a pension from the gov. but the war is over with now and I will do anything that is right for an old Confederate. This old man is needy, and worthy. Please let me hear from you.

Very respectful, John W. Wilkerson Siloam Springs MO

GENERAL'S OFFICE
55183
DEPARTMENT.

1913

2055183

WAR DEPARTMENT,
THE ADJUTANT GENERAL'S OFFICE
WASHINGTON, July 8, 1913.

Respectfully returned to

Mr. John W. Wilkerson,
Siloam Springs, Missouri.

Under the rules of this Department information from the official records cannot be furnished for use in the prosecution of a claim for pension. Nor is it necessary that such information should be furnished for that purpose, because all the data afforded by the official records in this Department that may have a bearing upon any such claim are always furnished, upon his request therefor, to the official charged by law with the adjudication of the claim.

No possible hardship can result from the operation of this rule, because all that it is necessary for a claimant for pension under the Missouri law to do is to make his claim to the Adjutant General of the state in accordance with his own knowledge of the facts, and to furnish such testimony as he may be called upon to furnish, being assured that all the information afforded by the official records in the War Department that has a bearing upon the claim will be promptly furnished to that official upon his request therefor.

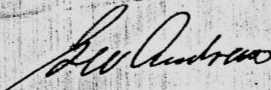

The Adjutant General.

H

(A. G. O. 74)

July 8, 1913

July 12 1913

Siloam Springs, Mo.,
7/12, 1913.

JUL 1 1913
Adjutant General,
Jefferson City, Mo.

Sir:-
Referring to the matter
of my application for a
pension as an Ex-Confederate
soldier under the Missouri
State law, will say I
informed you that my
discharge was lost.
The last application blank
sent from your office
demanded a discharge, or
a certificate of service
from the War Department,
Washington, D. C. This
a friend of mine tried

To procure for me
as the letter and the
reply from the War
Department, enclosed
herewith will show you.

Must confess that
I am out of patience
with this matter. Of course
I need the pension, or
I would not applied for
same. You are the one
to procure the information
from the war department.
Please let me know
soon as possible as
to the action you will
take in my case, if any.
Respectfully,
R.C. Allred.

Siloam Springs, MO., 7/12, 1913
Adjutant General, Jefferson City, MO.

Sir:

Referring to the matter of my application for a pension as an ex-confederate soldier under the Missouri State law, will say I informed you that my discharge was lost. The last application blank sent from your office demanded a discharge, or a certificate of service from the War Department, Washington, D.C. This friend of mine tried to procure for me as the letter and the reply from the War Department enclosed herewith will show you.

Must confess that I am out of patience with this matter. Of course I need the pension or I would not applied for same. You are the one to procure the information from the War Department.

Please let me know soon as possible as to the action you will take in my case, if any.

Respectfully,

R.C. Allred

Siloam Springs MO

June 10 13

STATE OF MISSOURI
THE ADJUTANT GENERAL'S OFFICE
CITY OF JEFFERSON

July 29, 1913

July 29, 1913.

The Adjutant General,
War Department,
Washington, D. C.

To enable the undersigned properly to adjudicate and pass upon the application for pension under State law (C.S.H.B. #465, copy of which has been furnished you), you are requested to furnish this department with all the data afforded by the records of your office relative to the time and place of enlistment, age, wounds or personal injury received, hospital record by reason of diseases contracted while in line of duty, and the time, place and manner of separation from service in the army of the late C. S. A. of

R. C. Allred,
Co. C. Capt. Wm. Cousin,
Regt. 2nd Cav. Col. White, Mo. Vols.

Thanking you in advance for this and any other necessary information in connection therewith which may occur to you in compiling the record, I remain,

Respectfully,



The Adjutant General

APPENDIX 18. Richard C. Allred Death Certificate

CAUSE OF DEATH in plain terms, so that it may be properly classified. Exact statement of OCCUPATION is very important.

PLACE OF DEATH		MISSOURI STATE BOARD OF HEALTH BUREAU OF VITAL STATISTICS CERTIFICATE OF DEATH	
County: <u>Howell</u>	Registration District No. <u>1110</u>	File No. <u>1122</u>	
Township: <u>Siloam Spgs.</u>	Primary Registration District No. <u>5541</u>	Registered No. <u>✓</u>	
Village: _____	(NO. _____ St. _____ Ward)	[If death occurred in a hospital or institution, give its NAME instead of street and number.]	
City: _____	FULL NAME <u>Richard C. Allred</u>		
PERSONAL AND STATISTICAL PARTICULARS		MEDICAL CERTIFICATE OF DEATH	
SEX: <u>Male</u>	COLOR OR RACE: <u>White</u>	SINGLE MARRIED WIDOWED OR DIVORCED (If wife the word): <u>Married</u>	DATE OF DEATH: <u>Jan. 28</u> 191 <u>7</u> (Month) (Day) (Year)
DATE OF BIRTH: <u>July 27</u> 18 <u>39</u> (Month) (Day) (Year)	I HEREBY CERTIFY, that I attended deceased from _____, 191__, to _____, 191__, that I last saw h. _____ alive on _____, 191__, and that death occurred, on the date stated above, at <u>5 a.m.</u>		
AGE: <u>76</u> yrs. <u>5</u> mos. <u>1</u> ds.	IF LESS than 1 day, ___ hrs. or ___ min.?		
OCCUPATION (a) Trade, profession, or particular kind of work: <u>Farmer</u>	The CAUSE OF DEATH* was as follows: <u>La grippe</u>		
(b) General nature of industry, business, or establishment in which employed (or employer): _____	<u>11B</u> <u>10</u> (Duration) ___ yrs. ___ mos. <u>8</u> ds.		
BIRTHPLACE (City or town, State or foreign country): <u>Yenn.</u>	Contributory (Secondary) _____ (Duration) ___ yrs. ___ mos. ___ ds.		
NAME OF FATHER: <u>Dontman</u>	(Signed) <u>W.S. Eckles Registrar</u> <u>1/30</u> 191 <u>7</u> (Address) <u>Siloam Spgs.</u>		
BIRTHPLACE OF FATHER (City or town, State or foreign country): <u>Yenn.</u>	*State the Disease Causing Death, or, in deaths from Violent Causes, state (1) Means of Injury; and (2) whether Accidental, Septic, or Hemipal.		
MAIDEN NAME OF MOTHER: <u>Dontman</u>	LENGTH OF RESIDENCE (FOR HOSPITALS, INSTITUTIONS, TRANSIENTS, OR RECENT RESIDENTS)		
BIRTHPLACE OF MOTHER (City or town, State or foreign country): <u>Dontman</u>	At place of death ___ yrs. ___ mos. ___ ds. In the State ___ yrs. ___ mos. ___ ds.		
THE ABOVE IS TRUE TO THE BEST OF MY KNOWLEDGE		Where was disease contracted if not at place of death? _____	
(Informant) <u>Mary B. Allred</u>	Former or usual residence: _____		
(ADDRESS) <u>Siloam Springs</u>	PLACE OF BURIAL OR REMOVAL: <u>Siloam Spgs. Cem.</u>	DATE OF BURIAL: <u>1/30</u> 191 <u>7</u>	
Filed <u>1/20</u> 191 <u>7</u> <u>W.S. Eckles</u> REGISTRAR	UNDERTAKER: <u>Jas. Copinger</u>	ADDRESS: <u>Siloam Spgs.</u>	

APPENDIX 19. Mary Allred, 1920 Census

1920 United States Federal Census for Mary C Allred
Oklahoma > Pawnee > Blackburn > District 0136

Street	House N	Dwelling	Visited	Name	Relation	Home O	Mortgage	Sex	Race	Age	Marital S	Year Imm	Naturaliz	Year Nat	Attended	Can Read	Can Write	Birthplace	Tongue	Birthplace of Father	Tongue of Father	Birthplace of Mother	Tongue of Mother	Speaks E	Occupation	Industry	Employer
	X 3	3		Smith, Edward	Head	W		M	W	36	M							Missouri		New York		Switzerland	French	Yes	None	Carriage	
				Alta S	Wife			F	W	29	M							Missouri		Indiana		Illinois	None	Yes	None		
				Mary	Daughter			F	W	5	S							Oklahoma		Indiana		Kansas	None	Yes	None		
				Madam	Son			M	W	9	S							Oklahoma		Missouri		Missouri	None	Yes	None		
				Robert	Son			M	W	5	S							Oklahoma		Missouri		Missouri	None	Yes	None		
	X 4	4		Howard	Head	W		M	W	32	M							Missouri		Missouri		Missouri	None	Yes	None	House PA	
				Allred, Mary	Wife			F	W	23	M							Missouri		Missouri		Missouri	None	Yes	None		
				Howard	Son			M	W	3	S							Missouri		Missouri		Missouri	None	Yes	None		
	X 5	5		Robert	Head	W		M	W	39	M							Missouri		Missouri		Missouri	None	Yes	None	Carriage	
				Carly	Wife			F	W	37	M							Kansas		Ohio		Pennsylvania	None	Yes	None		

APPENDIX 20. Mary Allred, 1930 Census

1930 United States Federal Census for Mary J Allred
Oklahoma > Pawnee > Blackburn > District 0003

House N	Dwelling	Family N	Name	Relation	Home O	Home Value	Radio	Farm	Sex	Race	Age	Marital S	Attended	Reads &	Birthplace	Father Birthplace	Mother B	Language	A	B	C	Immigrat	Naturaliz	Speaks E	Occupation	Industry	D	Worker C	Employe	Unempl	Veteran	War
7	3		Mary	Daughter					F	W	10	S			Missouri	Missouri	Missouri						Yes	None	None							
4	4		Ros	Daughter					F	W	10	S			Missouri	Missouri	Missouri						Yes	None	None							

APPENDIX 21. Mary Caroline Wright Allred Death Certificate

STANDARD CERTIFICATE OF DEATH		DEPARTMENT OF COMMERCE BUREAU OF THE CENSUS	
PLACE OF DEATH: <u>Pawnee</u>		410	
City <u>Pawnee</u> State <u>OKLAHOMA</u> Registered No. <u>714</u>			
Township <u>Bledsoe</u> No. _____ or Village _____ St. _____ Ward _____			
(If death occurred in a hospital or institution, give its NAME instead of street and number)			
Date of residence in city or town where death occurred _____ yrs. _____ mos. _____ days. How long in U. S., if of foreign birth? _____ yrs. _____ mos. _____ days.			
LEGAL NAME <u>Mary Caroline Allred</u>		<u>59-17</u>	
Residence No. _____ St. <u>403</u> Ward _____ (If nonresident, give city or town and State)			
PERSONAL AND STATISTICAL PARTICULARS		MEDICAL CERTIFICATE OF DEATH	
1. SEX <u>W</u> 4. COLOR OR RACE <u>W</u> 5. SINGLE, MARRIED, WIDOWED, OR DIVORCED (write the word) <u>Widowed</u>		21. DATE OF DEATH (month, day, and year) <u>1/5</u> 193 <u>5</u>	
2. MARRIED, WIDOWED, OR DIVORCED (write the word) _____		22. I HEREBY CERTIFY, That I attended deceased from <u>Dec 24</u> , 193 <u>5</u> , to <u>Jan 5</u> , 193 <u>5</u>	
3. HUSBAND or WIFE of _____		I last saw her alive on <u>Jan 4</u> , 193 <u>5</u> ; death is said to have occurred on the date stated above, at <u>10</u> a.m.	
6. DATE OF BIRTH (month, day, and year) <u>3/18/1844</u>		The principal cause of death and related causes of importance were as follows:	
7. AGE <u>90</u> <u>9</u> <u>17</u> hrs. or mins.		<u>Asphyxia from suffocation with pneumonia</u>	
8. TRADE, PROFESSION, OR PARTICULAR KIND OF WORK DONE AS SPINNER, SAWYER, BOOKKEEPER, ETC. <u>Hammer</u>		Date of onset _____	
9. INDUSTRY OR BUSINESS IN WHICH WORK WAS DONE, AS SILK MILL, SAWMILL, BASK, ETC. _____		Other contributory causes of importance: <u>Age 119</u>	
10. DATE DECEASED LAST WORKED AT THIS OCCUPATION (month and year) _____ 11. Total time (years) spent in this occupation _____		Name of operation <u>none</u> Date of _____	
12. PLACE (city or town and State or country): <u>Mo</u>		What test confirmed diagnosis? <u>none</u> Was there an autopsy? <u>no</u>	
13. NAME: <u>Wright</u>		23. If death was due to external causes (violence), fill in also the following:	
14. BIRTHPLACE (city or town and State or country): <u>Don't know</u>		Accident, suicide, or homicide? _____ Date of injury _____, 193 <u>5</u>	
15. MAIDEN NAME: <u>Don't know</u>		Where did injury occur? (Specify city or town, county, and State)	
16. BIRTHPLACE (city or town and State or country): <u>Don't know</u>		Specify whether injury occurred in industry, in home, or in public place:	
17. PERMANENT (name and address): <u>Harley Allred, Bledsoe</u>		Manner of injury <u>✓</u>	
18. PLACE OF BURIAL, CREMATION, OR REMOVAL: <u>Cleveland</u> Date <u>1/6</u> , 193 <u>5</u>		Nature of injury _____	
19. NEXT OF KIN (name and address): <u>Chas. H. Huffelt, Okla. City</u>		24. Was disease or injury in any way related to occupation of deceased? _____	
20. REGISTRAR (name and address): <u>Chas. H. Huffelt, Okla. City</u>		If so, specify (Signed) <u>Alfred V. Hildner</u> (Address) <u>110 North 1st St. Okla. City</u>	

APPENDIX 22. Viola Virginia Allred and William Henry Gilbert, Marriage Certificate

MARRIAGE LICENSE.

Sec. 2844, R. S. 1892.

STATE OF MISSOURI, COUNTY OF HOWELL.

This license authorizes any Judge, Justice of the Peace, licensed or ordained Preacher of the Gospel, or any other person authorized under the Laws of this State, TO SOLEMNIZE Marriage between William H. Gilbert of Saline Springs County of Howell and State of Mo., who is of the age of twenty-one years, and Viola V. Allred of Saline Springs in the County of Howell and State of Mo., who is of the age of eighteen years.

WITNESS my hand as Recorder, with the seal of office hereto affixed, at my office in West Plains, the

7th day of August 1901.

J. W. Leary Recorder.

By Deputy.

STATE OF MISSOURI,

COUNTY OF HOWELL.

THIS IS TO CERTIFY, that the undersigned George DeLancy, M.D. did at Saline Springs to said County, on the 7th day of August A. D. 1901 unite in Marriage the above named persons.

Filed for Record Sept 21st 1901

J. W. Leary Recorder.

APPENDIX 23. William Henry Gilbert Records, 1900, 1910, 1920, 1930

1900 United States Federal Census for Viola V Gilbert
Arkansas > Randolph > Maynard > District 0112

Line No	Street	House	Family	Name	Relation to Head	Race	Sex	Birth Yr	Age	Marital	Years	Children	Birthplace	Father's Birthplace	Mother's Birthplace	Immig	Years	Natural	Occupation	Month	Attend	Can Re	Can W	Can Sp	Owned	Farm C	
5				Viola V Gilbert	Sister	W	F	1877	22	Mar	10	10	Missouri	Indiana	Indiana				School Teacher	0	yes	yes	yes	yes	26	5	
6		2	2	William H Gilbert	Head	W	M	1861	37	Mar	10	10	Georgia	Georgia	Georgia				Photographer	0	yes	yes	yes	yes	26	5	
7				Viola V	Wife	W	F	1877	22	Mar	10	10	Missouri	Georgia	Missouri												7
8				John R	Son	W	M	1892	7	Un	10	10	Missouri	Georgia	Missouri												8
9				John R	Son	W	M	1894	6	Un	10	10	Arkansas	Georgia	Missouri												9
10				Adithal C	Son	W	M	1895	5	Un	10	10	Missouri	Georgia	Missouri												10
11				Robt L	Son	W	M	1892	8	Un	10	10	Missouri	Georgia	Missouri												11

1910 United States Federal Census for Viola V Gilbert
Arizona > Maricopa > Alma > District 0052

Line No	Name	Relation	Race	Sex	Birth Yr	Age	Marital	Years	Children	Birthplace	Father's Birthplace	Mother's Birthplace	Immig	Years	Natural	Occupation	Industry	D	Em	Unert	Vet	Var	
34	Viola V Gilbert	Sister	W	F	1877	32	Mar	10	10	Missouri	Indiana	Indiana				School Teacher							
35	William H Gilbert	Head	W	M	1861	47	Mar	10	10	Georgia	Georgia	Georgia				Photographer							

1920 United States Federal Census for Viola V Gilbert
Arizona > Yavapai > Prescott > District 0118

Line No	Name	Relation	Race	Sex	Birth Yr	Age	Marital	Years	Children	Birthplace	Father's Birthplace	Mother's Birthplace	Immig	Years	Natural	Occupation	Industry	D	Em	Unert	Vet	Var	
83	Viola V Gilbert	Sister	W	F	1877	42	Mar	10	10	Missouri	Indiana	Indiana				School Teacher							
84	William H Gilbert	Head	W	M	1861	57	Mar	10	10	Georgia	Georgia	Georgia				Photographer							

1930 United States Federal Census for Viola V Gilbert
New Mexico > Catron > Datil > District 0009

Line No	Name	Relation	Race	Sex	Birth Yr	Age	Marital	Years	Children	Birthplace	Father's Birthplace	Mother's Birthplace	Immig	Years	Natural	Occupation	Industry	D	Em	Unert	Vet	Var	
20	Viola V Gilbert	Sister	W	F	1877	52	Mar	10	10	Missouri	Indiana	Indiana				School Teacher							
21	William H Gilbert	Head	W	M	1861	67	Mar	10	10	Georgia	Georgia	Georgia				Photographer							